

NOTES:

- 1. SUBSTRATE
- 2. SURFACE S2 TO BE PARALLEL WITH SURFACE S1 TO WITHIN 5 arcsec
- 3. COATING (APPLY ACROSS COATING APERTURE)
ENVIRONMENTAL DURABILITY:
PHYSICAL DURABILITY:
PERFORMANCE SPECIFICATIONS:
T(avg): >85% FROM 625 - 1600nm FOR RANDOM POLARIZATION @ 45° AOI
T(abs): >80% FROM 625 - 1600nm FOR ALL POLARIZATIONS @ 45° AOI
R(avg): >97% FROM 460 - 570nm FOR RANDOM POLARIZATION @ 45° AOI
R(abs): >95% FROM 460 - 570nm FOR ALL POLARIZATIONS @ 45° AOI
T(abs): = 50% 600nm @ 45° AOI
- S1: HARD COATED
S2: SINGLE LAYER MgF2

4. FINE GRIND SURFACE

- 5. POWER, IRREGULARITY, AND SURFACE QUALITY SPECIFICATIONS
APPLY ACROSS CLEAR APERTURE
- 6. TRANSMITTED WAVEFRONT DISTORTION RMS@ 632.8nm ≤ ¼ λ
- 7. ROHS COMPLIANT

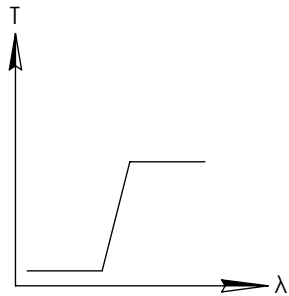

LONGPASS FILTER

FOR INFORMATION ONLY:
DO NOT MANUFACTURE
PARTS TO THIS DRAWING

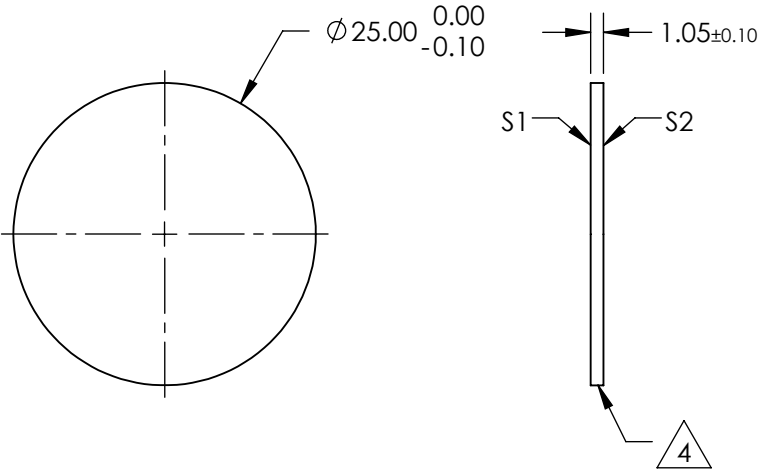
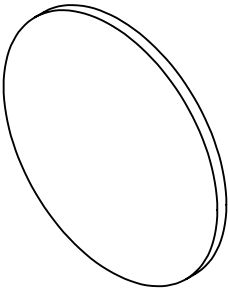

SPECIFICATIONS SUBJECT TO CHANGE WITHOUT NOTICE
DIMENSIONS ARE FOR REFERENCE ONLY

	S1	S2
SHAPE	PLANO	PLANO
SURFACE QUALITY	60-40	60-40
CLEAR APERTURE	Ø22.00	Ø22.00
BEVEL	PROTECTIVE AS NEEDED	PROTECTIVE AS NEEDED

Edmund Optics®



ALL DIMS IN

mm

TITLE

Ø25mm, 600nm DICHROIC LONGPASS FILTER

DWG NO

69890

SHEET
1 OF 1