

NOTES:

1. SUBSTRATE MATERIAL:
BOROFLOAT®
2. COATING (APPLY ACROSS CLEAR APERTURE)

S1: NONE
S2: NONE
3. POWER, IRREGULARITY, SURFACE QUALITY, AND COATING
SPECIFICATIONS APPLY ACROSS CLEAR APERTURE
4.

FINE GROUND SURFACE
5. ROHS COMPLIANT

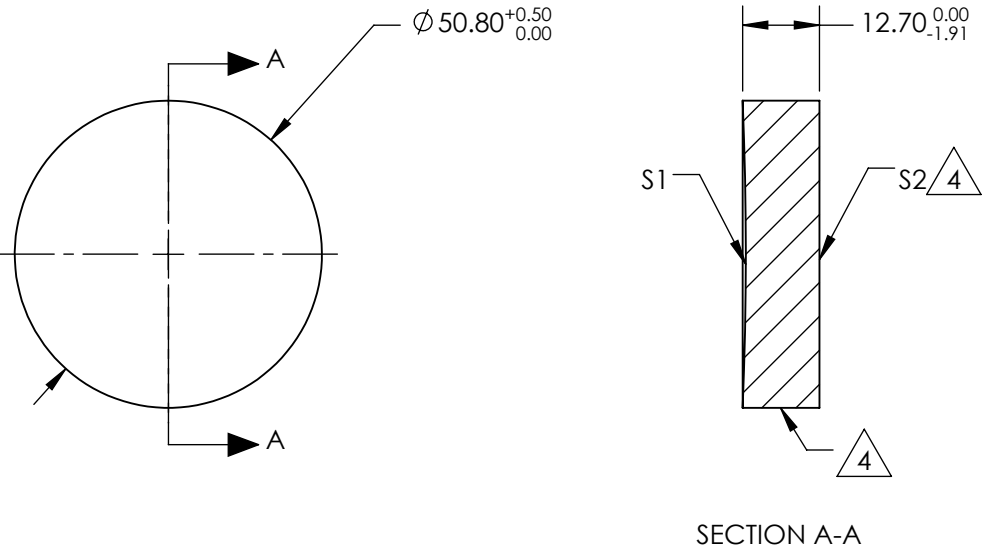

**FOR INFORMATION ONLY:
DO NOT MANUFACTURE
PARTS TO THIS DRAWING**

SPECIFICATIONS SUBJECT TO CHANGE WITHOUT NOTICE
DIMENSIONS ARE FOR REFERENCE ONLY

REV. A	S1	S2				
SHAPE	CONCAVE	PLANO				
EFFECTIVE FOCAL LENGTH	304.8mm	N/A				
FOCAL LENGTH TOLERANCE	±2%	N/A				
APERTURE	f/6	N/A				
SURFACE QUALITY	60-40	60-40				
SURFACE FLATNESS	λ/4	λ/4				
BEVEL	PROTECTIVE AS NEEDED	PROTECTIVE AS NEEDED				

THIRD ANGLE
PROJECTION

ALL DIMS IN

mm

TITLE

2" Dia, 12" FL Enhanced Alum., Spherical Mirror

DWG NO

43548

SHEET
1 OF 1

Edmund Optics®