

NOTES:

1. SUBSTRATE MATERIAL:
N-BK7
2. COATING (APPLY ACROSS CLEAR APERTURE)
- S1 & S2: MgF2 (400-700nm)
R(AVG) ≤1.75% @ 400 - 700nm
3. FINE GROUND SURFACE
4. RoHS COMPLIANT

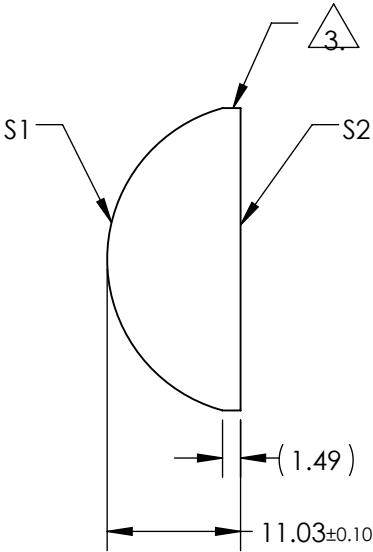
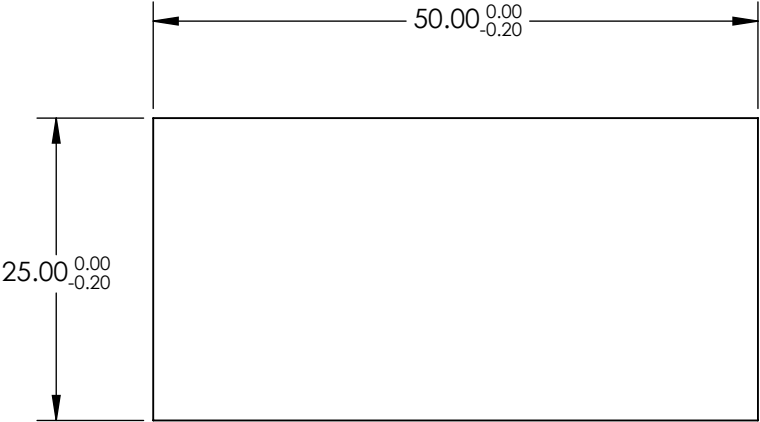

**FOR INFORMATION ONLY:
DO NOT MANUFACTURE
PARTS TO THIS DRAWING**

SPECIFICATIONS SUBJECT TO CHANGE WITHOUT NOTICE
DIMENSIONS ARE FOR REFERENCE ONLY

	S1	S2	EFL	25.00	 Edmund Optics®		
SHAPE	CONVEX	PLANO	BFL	17.74			
RADIUS	12.96	INFINITY			TITLE	25mm H X 50mm L X 25mm FL MGF2 COATED, CYLINDER LENS	
SURFACE QUALITY	60-40	60-40					
CLEAR APERTURE	24.00 x 49.00	24.00 x 49.00			DWG NO	48363	
BEVEL	PROTECTIVE AS NEEDED	PROTECTIVE AS NEEDED					
					ALL DIMS IN	mm	