

NOTES:

1. SUBSTRATE MATERIAL:  
N-BK7
2. COATING (APPLY ACROSS CLEAR APERTURE)

S1 & S2: VIS-NIR (400-1000nm)  
R(ABS)  $\leq 0.25\%$  @ 880nm  
R(AVG)  $\leq 1.25\%$  @ 400 - 870nm  
R(AVG)  $\leq 1.25\%$  @ 890 - 1000nm

3. FINE GROUND SURFACE

4. RoHS COMPLIANT

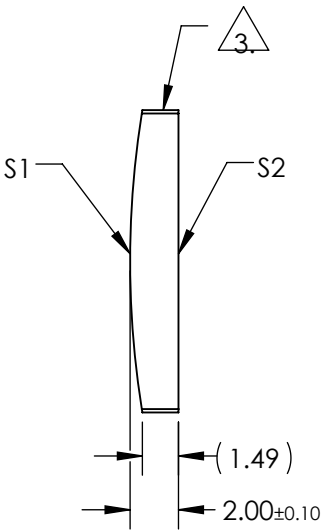
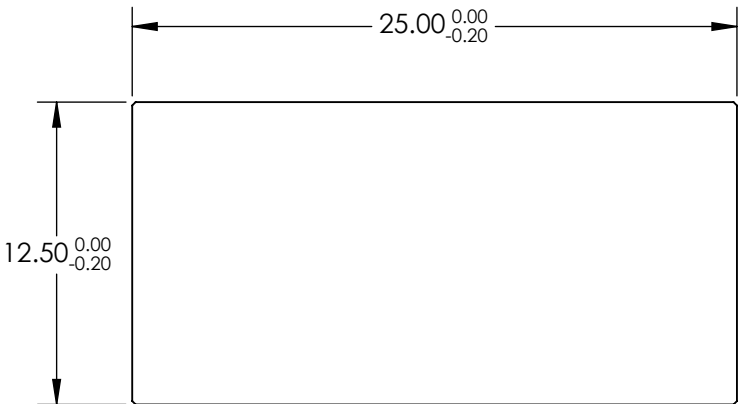

**FOR INFORMATION ONLY:  
DO NOT MANUFACTURE  
PARTS TO THIS DRAWING**

SPECIFICATIONS SUBJECT TO CHANGE WITHOUT NOTICE  
DIMENSIONS ARE FOR REFERENCE ONLY

	S1	S2	EFL	75.00	 <b>Edmund Optics®</b>		
SHAPE	CONVEX	PLANO	BFL	73.68			
RADIUS	38.76	INFINITY			TITLE	12.5mm H X 25mm L X 75mm FL VIS-NIR COATED, CYLINDER LENS	
SURFACE QUALITY	60-40	60-40					
CLEAR APERTURE	11.50 x 24.00	11.50 x 24.00	ALL DIMS IN		DWG NO	69776	SHEET 1 OF 1
BEVEL	PROTECTIVE AS NEEDED	PROTECTIVE AS NEEDED					