

NOTES:

1. SUBSTRATE MATERIAL:
Fused Silica
2. COATING (APPLY ACROSS CLEAR APERTURE)

S1: Enhanced Aluminum
R(avg) >95% @ 450 - 650nm

S2: NONE
3. FINE GROUND SURFACE
4. PARALLELISM: 30 ARCSEC
5. RoHS COMPLIANT

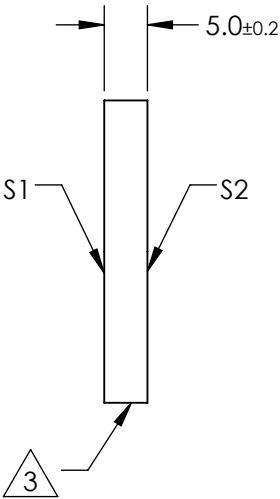
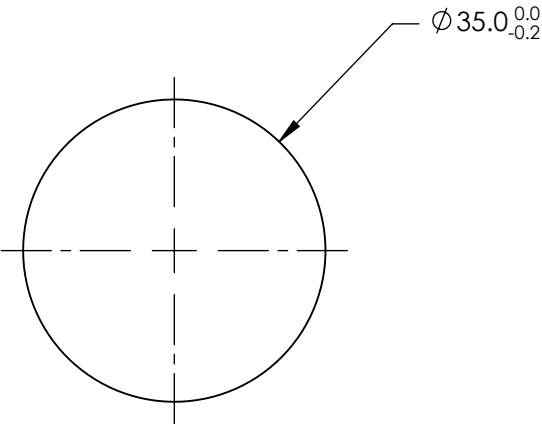

**FOR INFORMATION ONLY:
DO NOT MANUFACTURE
PARTS TO THIS DRAWING**

SPECIFICATIONS SUBJECT TO CHANGE WITHOUT NOTICE
DIMENSIONS ARE FOR REFERENCE ONLY

REV. A	S1	S2	<div><div><div>EO[®]</div><div>Edmund Optics[®]</div></div><div><div>TITLE</div><div>35mm Diameter Enhanced Aluminum Coated, λ/10 Mirror</div></div><div><div>DWG NO</div><div>84413</div></div><div><div>SHEET</div><div>1 OF 1</div></div></div>	
SHAPE	PLANO	PLANO		
SURFACE QUALITY	20-10	N/A		
SURFACE FLATNESS	λ/10	COMMERICAL POLISH		
CLEAR APERTURE	90%	N/A		
BEVEL	PROTECTIVE AS NEEDED	PROTECTIVE AS NEEDED	ALL DIMS IN	mm