

NOTES:

1. COATING (APPLY ACROSS CLEAR APERTURE)
LASER V-COAT
R(ABS) ≤ 0.25% @ 405nm
2. ROHS: COMPLIANT

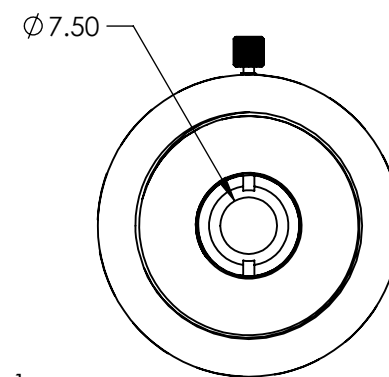
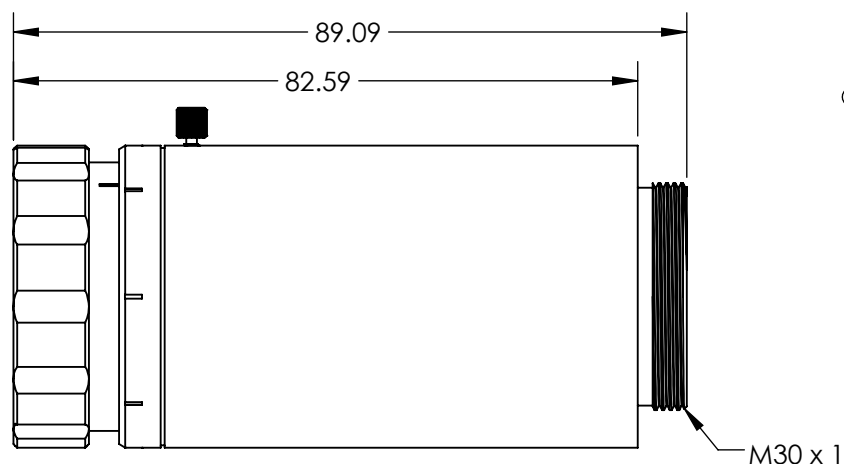
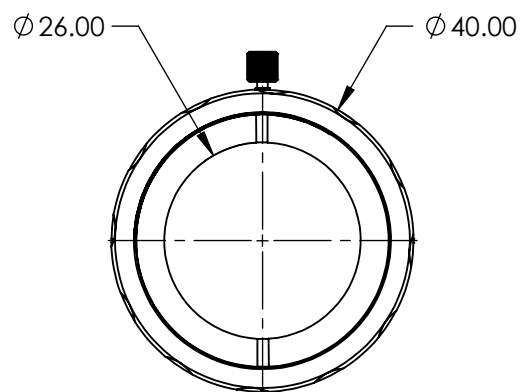
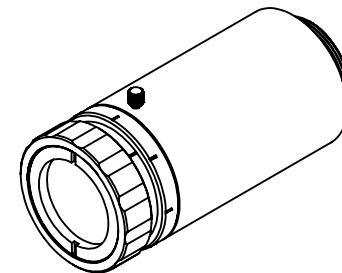

**FOR INFORMATION ONLY:
DO NOT MANUFACTURE
PARTS TO THIS DRAWING**

SPECIFICATIONS SUBJECT TO CHANGE WITHOUT NOTICE
DIMENSIONS ARE FOR REFERENCE ONLY

DAMAGE THRESHOLD, (PULSED)	3.0 J/cm ² @ 10ns, 20Hz, 405nm
DESIGN WAVELENGTH DWL (nm)	405nm
EXPANSION POWER	10X
TRANSMISSION %	>98.5 (nominal)
TRANSMITTED WAVEFRONT, P-V	<λ/10 for 2.3mm input beam (nominal)



ALL DIMS IN mm

EO® **Edmund Optics**®

TITLE

10X, 405nm Vega™ Laser Line Beam
Expander

DWG NO

37999

SHEET
1 OF 1