

- NOTES:
- 1. SUBSTRATE:  
H-K9L
  - 2. COATING (APPLY ACROSS CLEAR APERTURE)  
  
S1: NONE  
S2: NONE
  - 3. CENTERING: ≤30 ARCMIN

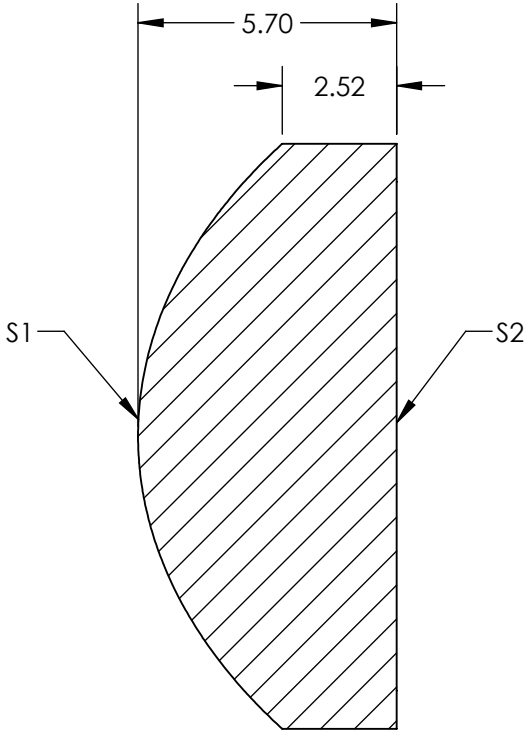
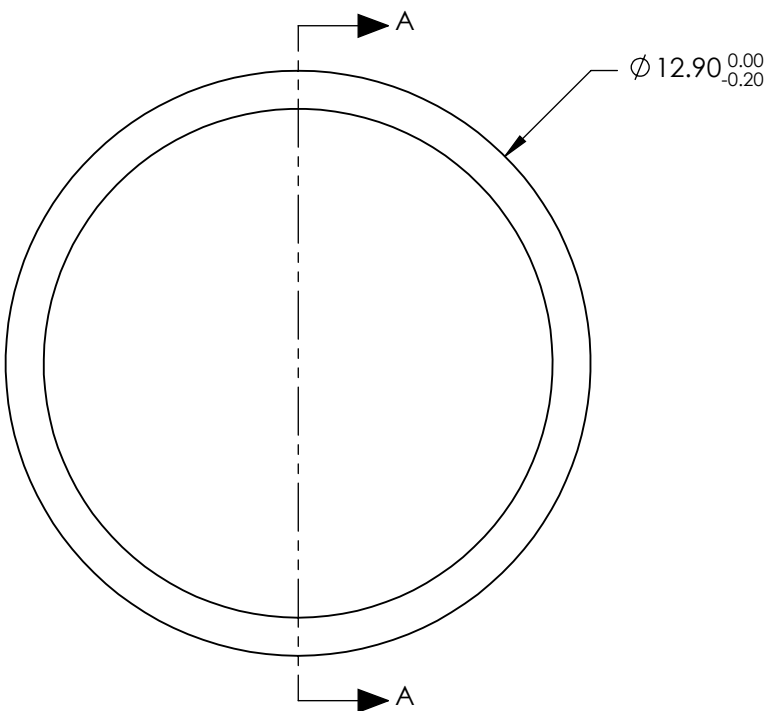

SECTION A-A

**FOR INFORMATION ONLY:  
DO NOT MANUFACTURE  
PARTS TO THIS DRAWING**

SPECIFICATIONS SUBJECT TO CHANGE WITHOUT NOTICE  
DIMENSIONS ARE FOR REFERENCE ONLY

	S1	S2
SHAPE	CONVEX	PLANO
SURFACE QUALITY	80-50 (typical)	80-50 (typical)
CLEAR APERTURE	Ø 11.60	Ø 11.60
BEVEL	PROTECTED AS NEEDED	PROTECTED AS NEEDED

EFL @ 587.6nm	14
BFL @ 587.6nm	10.2
THIRD ANGLE PROJECTION	
ALL DIMS IN	mm

Edmund Optics®			
TITLE		12.9mm Dia. x 14mm FL, Aspheric Condenser Lens	
DWG NO		19513	SHEET 1 OF 1