

NOTES:

- 1. SUBSTRATE: N-BK7
- 2. ROHS COMPLIANT
- 3. COATING (APPLY ACROSS CLEAR APERTURE)

S1: Ravg >85% @ 250 - 700nm;
Ravg >89% @ 250 - 450nm

S2: NONE

4. FINE GRIND SURFACE

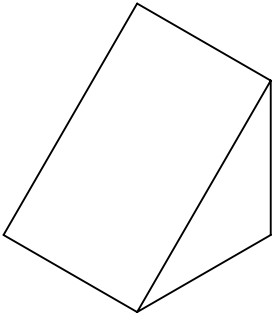
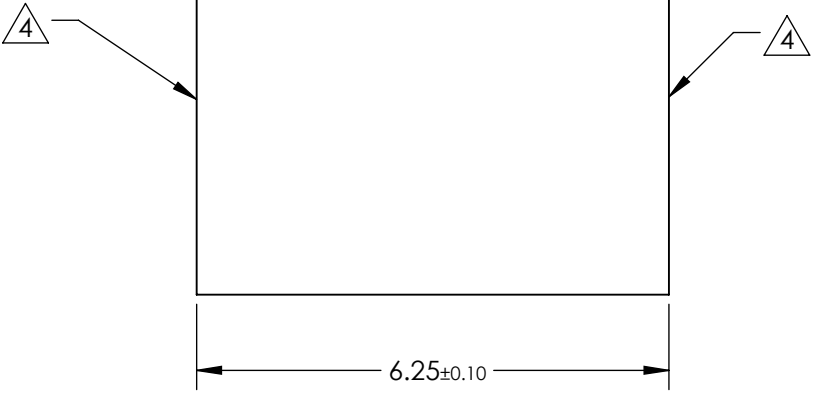
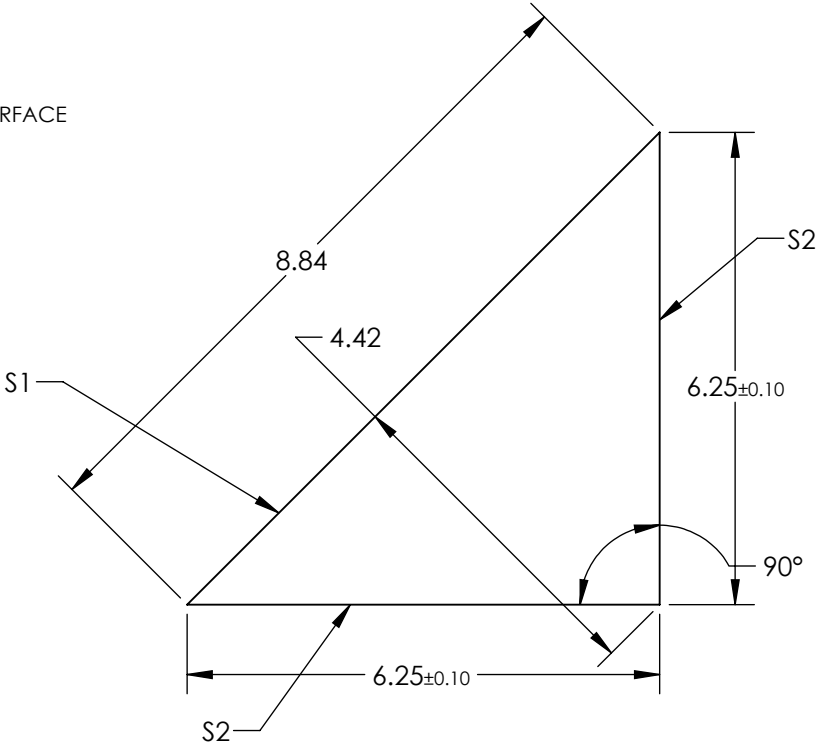

**FOR INFORMATION ONLY:
DO NOT MANUFACTURE
PARTS TO THIS DRAWING**

SPECIFICATIONS SUBJECT TO CHANGE WITHOUT NOTICE
DIMENSIONS ARE FOR REFERENCE ONLY

	S1	S2
SHAPE	PLANO	PLANO
ANGLE TOL. (arcmin)	±2	±2
SURFACE QUALITY	60-40	60-40
SURFACE FLATNESS	λ/4	λ/4
BEVEL	PROTECTED AS NEEDED	PROTECTED AS NEEDED

THIRD ANGLE
PROJECTION

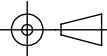

ALL DIMS IN

mm



Edmund Optics®

TITLE

6.25mm UV-Enhanced Aluminum Coated, N-BK7 Right Angle Prism

DWG NO

24177

SHEET
3 OF 13