

NOTES:

- 1. SUBSTRATE: N-BK7
- 2. ROHS COMPLIANT
- 3. COATING (APPLY ACROSS CLEAR APERTURE)

S1: Ravg >85% @ 250 - 700nm;
Ravg >89% @ 250 - 450nm

S2: NONE

4. FINE GRIND SURFACE

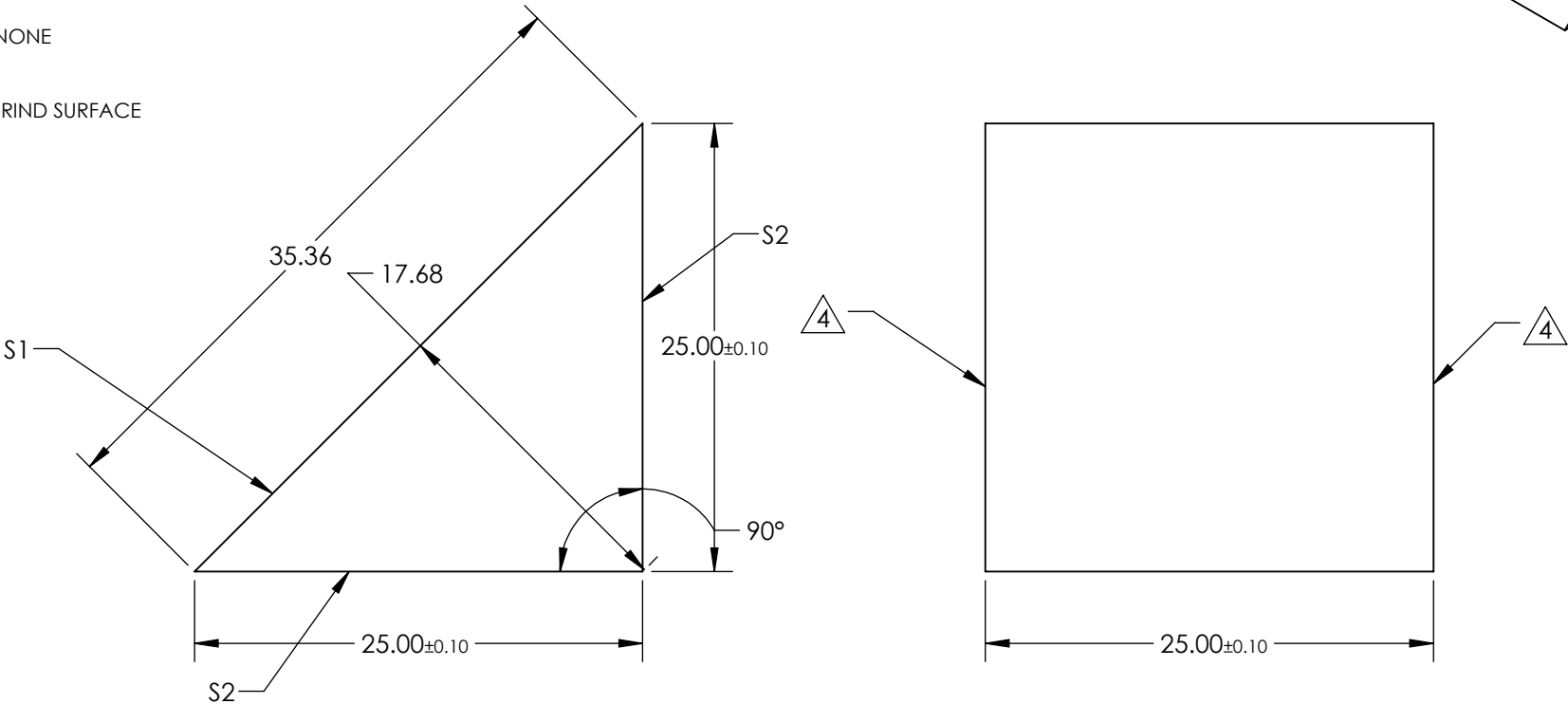

FOR INFORMATION ONLY:
DO NOT MANUFACTURE
PARTS TO THIS DRAWING

SPECIFICATIONS SUBJECT TO CHANGE WITHOUT NOTICE
DIMENSIONS ARE FOR REFERENCE ONLY

| | S1 | S2 |
|---------------------|---------------------|---------------------|
| SHAPE | PLANO | PLANO |
| ANGLE TOL. (arcmin) | ±2 | ±2 |
| SURFACE QUALITY | 60-40 | 60-40 |
| SURFACE FLATNESS | λ/4 | λ/4 |
| BEVEL | PROTECTED AS NEEDED | PROTECTED AS NEEDED |

Edmund Optics®



ALL DIMS IN

mm

TITLE

25mm UV-Enhanced Aluminum Coated, N-BK7 Right Angle Prism

DWG NO

24182

SHEET
8 OF 13